

Secure Safe

INFA GROUP



CS2213 / CS2313

SUITABLE FROM BIRTH TO SIX MONTHS*

REARWARD FACING

Suitable for children from birth to approximately 6 months* of age.

Instruction Manual

IMPORTANT: KEEP THIS BOOKLET IN THE PLACE PROVIDED ON THE CHILD RESTRAINT

*All references to age are approximates only and reference to children of average proportions. Children vary in shapes and sizes. The photo displayed is indicative of the type of restraint and may vary slightly depending on the model.



Australian Standard

AS/NZS: 1754:2013
Licence No. 25324-1
SAI Global

Quick Reference Guide

Base Unit - Seat Belt Installation

SET-UP

REFER TO PAGES 19 - 24

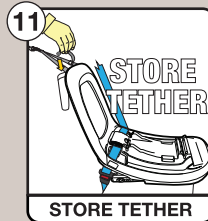
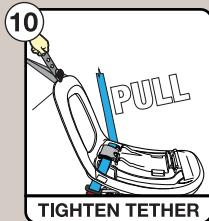
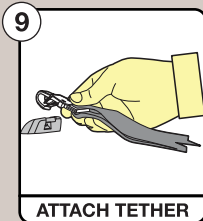
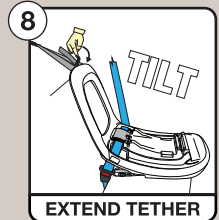
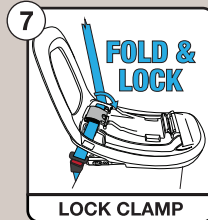
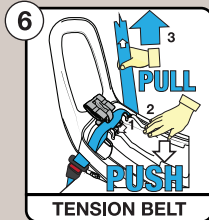
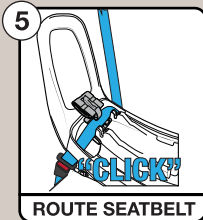
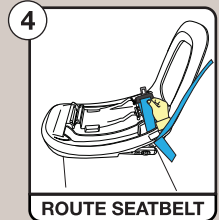
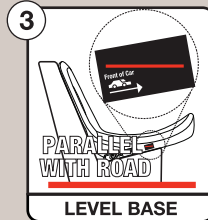
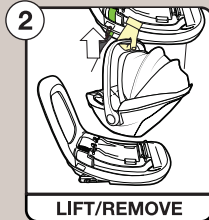
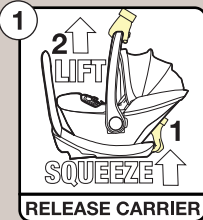

Quick Reference Guide

Page QR2

Base Unit - ISOFIX compatible Installation

SET-UP

REFER TO PAGES 25 - 29

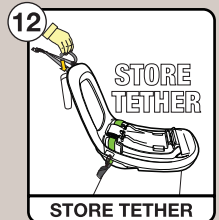
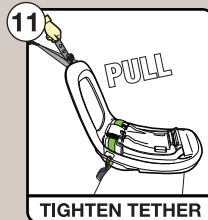
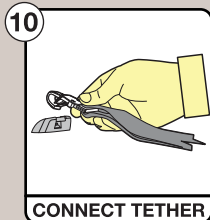
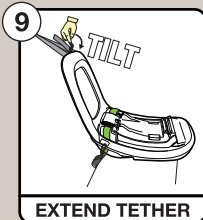
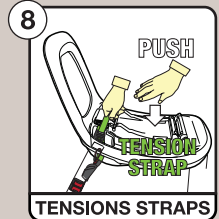
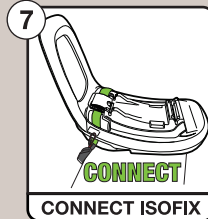
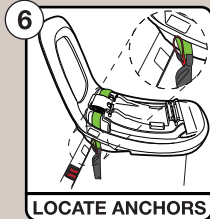
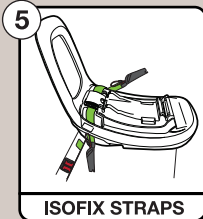
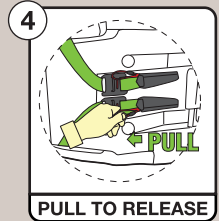
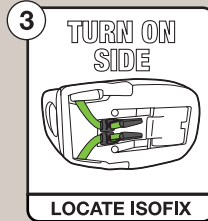
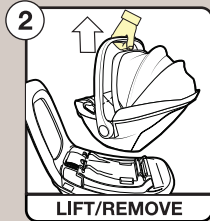
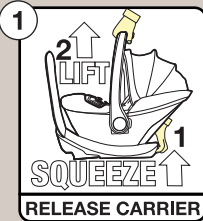

Quick Reference Guide

Infant Carrier - Harness Adjustment

SET-UP

REFER TO PAGES 30 - 32

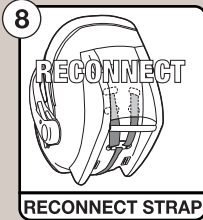
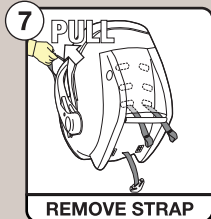
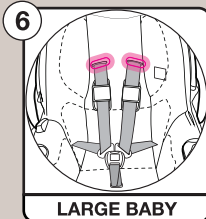
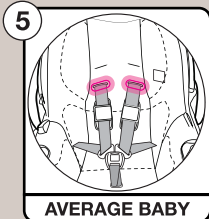
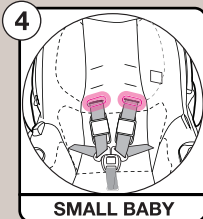
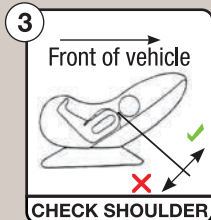
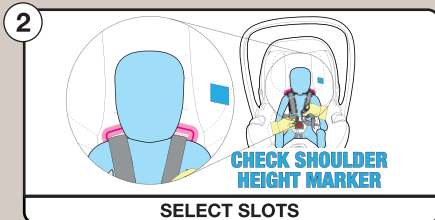
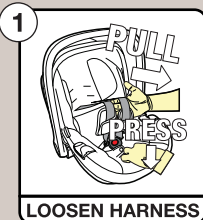

NOTE: ENSURE HARNESS STRAPS ARE BEHIND BAR

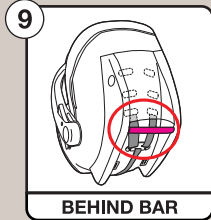

Infant Carrier - Harness Adjustment

SET-UP

REFER TO PAGES 33 - 39

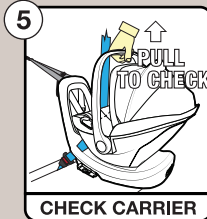
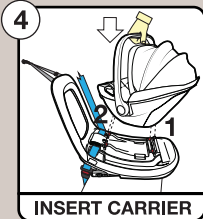
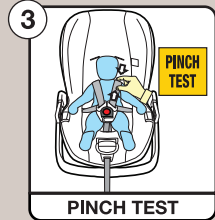
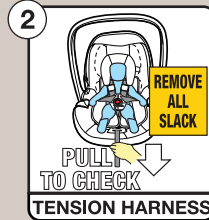
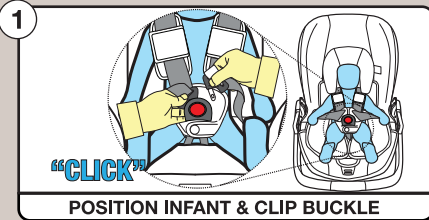

Contents

| | |
|---|----|
| Contents | 1 |
| Information | 2 |
| Warnings | 4 |
| Restraint Guide | 6 |
| Padding - Combination Guide | 7 |
| Infant Seat | |
| Information | 8 |
| Shoulder Height Markers | 9 |
| CS2213/CS2313 Child Restraints (Itemised List) | 11 |
| Next Restraint | 14 |
| General | |
| - Information | 15 |
| - Adjusting the Handle Position | 16 |
| Set Up - Base | |
| - Base | 17 |
| - Recline Angle | 18 |
| • Base Adjustment | 19 |
| Installation - Base | |
| - Installing Base Using Vehicle Seatbelts | 21 |
| - Smart Tether Top Tether Strap | 23 |
| ISOFIX Compatible Restraint | |
| - ISOFIX Lower Anchorages | 25 |
| • Installing Base using flexible ISOFIX Lower Anchorage Connectors (LAC) | 26 |
| Set Up - Carrier | |
| - Infant Carrier | 29 |
| • Correct Slot Height | 29 |
| • Adjusting Shoulder Strap Height | 29 |
| • Buckle Height Adjustment | 32 |
| Use - Carrier | |
| - Using Harness | 33 |
| - Carrier into Base | 36 |
| - Carrier from Base | 37 |
| - Removing Infant from Infant Carrier | 38 |
| Aircraft Use | |
| - How to Install into the Aircraft | 39 |
| - Fit Infant Carrier Into Aircraft Seat | 39 |
| Care Of Restraint | |
| - Care and Maintenance | 41 |
| - Cleaning | 42 |
| Remove And Replace Covers | 44 |
| Extension Straps | 44 |
| Accessories | 45 |
| Anchorage Fittings | |
| - For Cars Fitted With Anchorage Points | 48 |
| - For Cars Not Fitted With Anchorage Points | 49 |
| Insurers Information | 50 |
| Lifetime Warranty | 54 |

Please read carefully the whole of the instructions for installation and, in the event of doubt about the method of installation, to consult SecureSafe or agent, or a child restraint fitter, or in New Zealand, to consult the agent for the vehicle.

Information

This instruction manual covers various models under the Model number CS2213/CS2313. These child restraints are installed in the rear of the vehicle and can only be used rearward-facing which offers the best level of protection for your child in a vehicle crash. They can either be installed in the vehicle using the vehicle seatbelt & the top tether strap, or if applicable, the Rigid ISOFIX attached to the vehicle's ISOFIX anchor & top tether strap. This infant carrier is designed to be used by children from birth up to approximately 6 months old.

CS2213 Infant Carrier
CS2313 Infant Carrier

either seatbelt or ISOFIX compatible installations
seatbelt installation only

Infa Group

Infa Group is a family owned and operated business located in Sydney, Australia. With over 65 Years experience in Juvenile Products, our mission is to deliver Safety and Innovation.

Infa Group strives to create a real difference for our customers. We design and manufacture safe, stylish and affordable Child Restraints and Nursery products. All products are engineered to a high quality and standard so that your young ones will be secure in an Infa Group product.

Child Restraints

No child restraint can guarantee absolute protection from injury in every crash. However, to ensure that your child gets all the protection designed into the restraint please read and follow the instructions exactly and use only SecureSafe recommended parts and accessories.



Information

Engage Plus

Engage Plus is a family of installation technologies, designed to work in unison to provide the highest quality installation for your child.

ISOFix (CS2213 Only)

ISOFix compatible installation allows you to use your vehicles ISOFix compatible anchorage points, allowing for an easy and secure installation.

EasyLock

The EasyLock belt clamp provides a firm installation when using the vehicle seatbelt. EasyLock ensures an easy yet high quality installation for all parents and users.

Smart Tether

The Smart Tether is an innovative engagement technology that provides the easiest installation on the market. The Top Tether connects the base to the vehicle seat allowing you to easily remove and insert the carrier without having to reinstall the top tether every time.



ENGAGE PLUS

Complete Installation System



ISOFix

ISOFix Compatible Installation



EasyLock

Belt Clamp

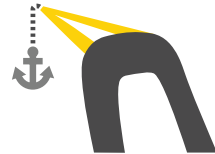

Smart Tether

Innovative Base Installation

Warnings



WARNINGS

- Use the restraint exactly as shown in the instructions.
- Supervision of children is needed because they may be able to undo buckles.
- **DO NOT LEAVE CHILDREN UNATTENDED IN THE CAR.**
- Do not alter or modify this restraint.
- Repairs must only be done by the manufacturers or agent.
- Do not allow the restraint to come into contact with polishes, oils, bleach and other chemicals.
- Destroy the restraint if it has been in a severe crash, even if no damage is visible.
- **DO NOT USE THIS RESTRAINT WITHOUT THE COVER.**
- To ensure infant's back is evenly supported, do not put more than one nappy on the baby and make sure the nappy is not thickly folded at the back.
- **DO NOT USE A REAR-FACING CHILD RESTRAINT WHERE AN AIRBAG IS FITTED IN FRONT OF THE SEATING POSITION.**
- Fit the restraint firmly to the car seat.
- Fit the harness firmly to the child.
- A loose restraint or harness is dangerous.
- Do not harness an infant wrapped in a blanket or swaddled. Any blanket or wrap must only be placed over the harness and infant.
- Always secure the loose end of the top tether strap. Do not use the child restraint where this strap may fall into a split in the seat back or off the side of the seat.
- **ALWAYS ATTACH HOOK AND REMOVE SLACK.**



WARNING

DO NOT LEAVE CHILDREN UNATTENDED IN THE CAR.

Warnings



WARNINGS

- THIS RESTRAINT IS NOT SUITABLE FOR USE WHERE THE TOP TETHER STRAP MAY FALL INTO A SPLIT IN THE SEAT BACK OR OFF THE SIDE OF THE SEAT.
- **THIS RESTRAINT MUST BE ATTACHED TO A CHILD RESTRAINT UPPER ANCHORAGE POINT IN THE CAR. REFER TO CAR OWNER'S HANDBOOK FOR LOCATION OF ANCHORAGE POINTS. REFER TO A CHILD RESTRAINT FITTING STATION IF NO ANCHORAGE POINTS ARE IN THE MOTOR CAR.**
- Always secure the loose end of the top tether strap to prevent it hanging out of the car or being accessible by the child.
- IF AN AIRBAG IS FITTED IN THE SEATING POSITION WHERE THE CHILD RESTRAINT IS TO BE FITTED, FOLLOW THE VEHICLE MANUFACTURER'S WARNINGS AND INSTRUCTIONS.

CS2213 ISOFIX COMPATIBLE



IMPORTANT

Do not attach the lower attachment connectors of two separate child restraints to the same ISOFIX low anchorages in your car.

Always attach the top tether strap to the child restraint upper anchorage in your car.

Child restraint lower attachment connectors and the ISOFIX low anchorages in your car are designed to withstand only those loads imposed by a correctly fitted child restraint.

CS2313 SEATBELT ONLY



IMPORTANT

This child restraint is not approved for use with any connectors that connect to the car's ISOFIX Low Anchorages.



IMPORTANT

- For a vehicle without a fixed parcel shelf an extension strap(s) may be needed. If so ring 1300 92 4632 (AU) or 067 590 870 (NZ) for nearest supply location (refer to page 44).
- Seatbelt extenders are not recommended to be used if the seatbelt is not long enough to secure the child restraint. If seatbelts are too short then advice should be sought from a child restraint fitter and their recommendation be considered before using a seatbelt extender.

Restraint Guide

MODE

REARWARD-FACING RESTRAINT

(TYPE A1)
BIRTH TO APPROX 6 MONTHS



CONVERTIBLE CAR SEAT

(TYPE A2/B)
BIRTH TO 4 YEARS



CONVERTIBLE CAR SEAT

(TYPE A4/B)
BIRTH TO 4 YEARS



CONVERTIBLE CAR SEAT

(TYPE A4/G)
BIRTH TO 8 YEARS



ZERO TO 8 CONVERTIBLE

CAR SEAT
(TYPE A2/B/E)
BIRTH TO 8 YEARS



FORWARD-FACING RESTRAINT

(TYPE B)
APPROX 6 MONTHS TO 4 YEARS



FORWARD-FACING RESTRAINT

(TYPE G)
APPROX 6 MONTHS TO 8 YEARS



CONVERTIBLE BOOSTER SEAT

(TYPE B/E)
APPROX 6 MONTHS TO 8 YEARS



BOOSTER SEAT

(TYPE E)
FROM APPROX 4 YEARS
TO 8 YEARS



BOOSTER SEAT

(TYPE F)
FROM APPROX 4 YEARS
TO 10 YEARS



SEAT BELT

FROM APPROX 7 YEARS
AND OVER

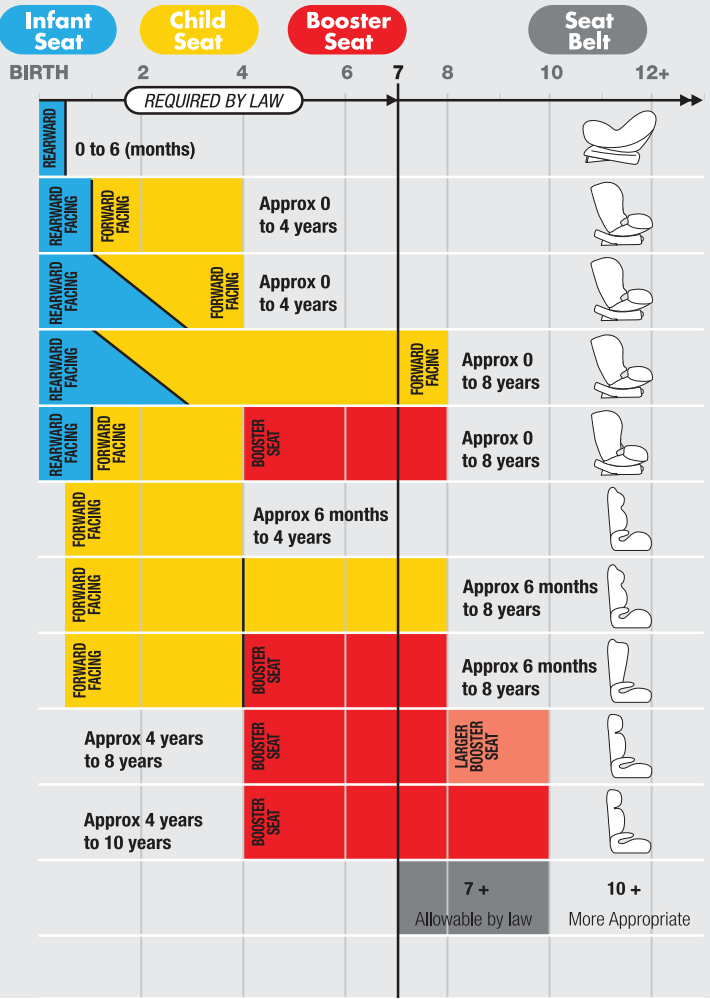

IMPORTANT: Research has shown that the likelihood of an accessory child safety harness being used incorrectly is very high and the risk of injuries when incorrectly used is much higher compared to a lap-sash seat belt. SecureSafe recommend that an accessory child safety harness should only be used if a lap-only seat belt is all that is available.

Padding / Inserts

Combination Guide

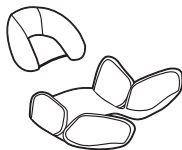

MODE

INFANT SEAT
(Small Infant)

REARWARD FACING



INFANT SEAT
(Large Infant)

REARWARD FACING



CS2213 Infant Carrier
CS2313 Infant Carrier

either seatbelt or ISOFIX compatible installations
seatbelt installation only

The Padded Insert/s (if fitted) are designed to provide extra support and comfort for small babies.
Discontinue use when the insert is a tight fit or creates discomfort for larger babies/children.

- Diagrams are indicative of type of paddings and inserts and may not resemble the actual product.
- Padded inserts can vary according to model.
- We reserve the right to alter this product without notice.

*For detailed description and method of attachment for padded accessories refer to Accessories on page 45.

THE SUITABILITY OF THE CHILD RESTRAINT TO GROUPS OF CHILDREN

TYPE A1

To be used only in a rearward-facing position until the infant's shoulders reach the lower shoulder height marker (approximately 6 months of age).

Continue to use this child restraint until the child reaches this limit.

Infants are at risk of serious injury if they face forward too early.

CS2213 ISOFIX COMPATIBLE INSTALLATION

TO BE USED WITH A LAP-SASH/LAP-ONLY SEAT BELT OR ISOFIX LOW ANCHORAGES IN THE BACK OF MOST CARS WITH FORWARD FACING SEATS.

CS2313 SEATBELT ONLY INSTALLATION

TO BE USED WITH A LAP-SASH/LAP-ONLY SEAT BELT IN THE BACK OF MOST CARS WITH FORWARD FACING SEATS.

The use of child restraints in the front seat may be restricted for children of specific ages by local legislation. Please check with your local Department of Transport for local Road Rules & for the specific seating locations of children using child restraints for their given ages.

If the baby's neck muscles are unable to support their head, then the infant should remain rear facing.

Always store the instruction manual in the place provided in the main cover when the infant carrier is removed.



WARNING

- ONLY USE RESTRAINT REARWARD-FACING.
- Do not use the restraint without the upper anchorage strap correctly attached.
- DO NOT USE A REAR-FACING CHILD RESTRAINT WHERE AN AIRBAG IS FITTED IN THE FRONT OF THE SEATING POSITION.
- Do not use on any vehicle seat which faces sideways or rearward.
- Do not use the child restraint facing forward.
- Do not use excessively upright or reclined.
- Do not use the aircraft seatbelt path in the car.

Shoulder Height Markers

Infant Seat
Rearward Facing

Small Infant

Shoulder height markers are provided on this restraint for a visual indication that the child is safe to travel in this restraint.

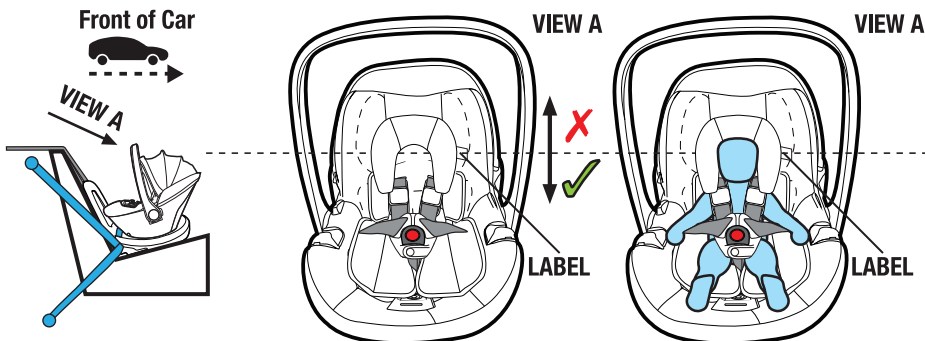

Shoulder height markers may be hidden under a pillow in the lowest position

To be used only in a rearward-facing position for an infant until their shoulders **REACH** the shoulder height marker (approximately 6 months of age).

LABEL
(Rearward -
Facing)



IMPORTANT

Ensure that you continue to use this child restraint in rearward facing positions whilst the infants shoulders are **below** this shoulder height marker.

Infants are at risk of serious injury if they face forward too early.

The Padded Insert/s (if fitted) are designed to provide extra support and comfort for small babies. Discontinue use when the insert is a tight fit or creates discomfort for larger babies/children.

If the infants shoulders are below the label or if the baby's neck muscles are unable to support their head, then the infant should remain rear facing.

Shoulder Height Markers

Infant Seat
Rearward Facing

Large Infant

Shoulder height markers are provided on this restraint for a visual indication that the child is safe to travel in this restraint.
Do not change to a forward facing restraint until the child's shoulder reaches the label.

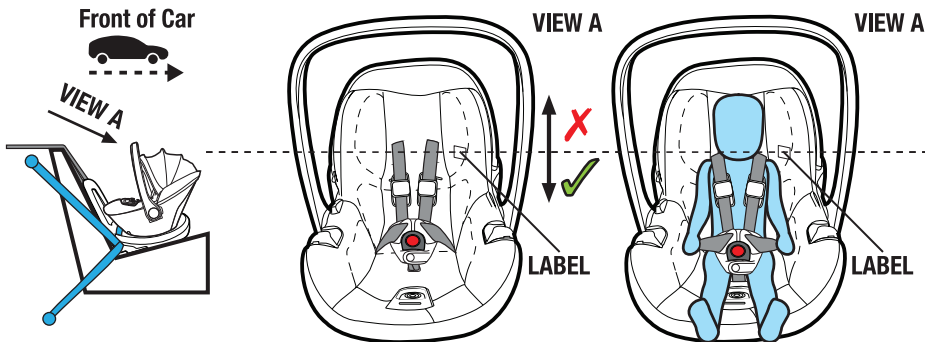

Shoulder height markers may be hidden under a pillow in the lowest position



IMPORTANT

DO NOT MOVE TO THE NEXT RESTRAINT TILL THE SHOULDERS REACH THE NEXT SHOULDER HEIGHT MARKER.

Infant Carrier

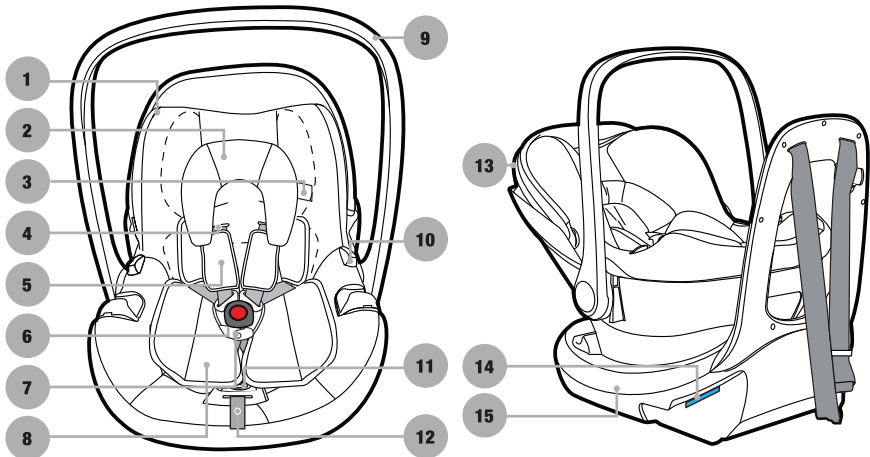

CS2213 Infant Carrier
CS2313 Infant Carrier

either seatbelt or ISOFIX compatible installations
seatbelt installation only

- | | |
|-------------------------------------|--|
| 1. Comfort Cover | 11. Harness Adjuster |
| 2. Pillow (if fitted) | 12. Harness Adjustment Strap |
| 3. Shoulder Height Marker | 13. Hood (if fitted) |
| 4. Harness Straps | 14. "REARWARD-FACING SEAT BELT PATH" Marker (each side of restraint - coloured blue) |
| 5. Shoulder Pads (if fitted) | 15. Base |
| 6. Buckle | |
| 7. Buckle Pad (if fitted) | |
| 8. Padded Insert (if fitted) | |
| 9. Carry Handle | |
| 10. Stroller Release Buttons | |

NOTE: Padded inserts can vary according to model.
For detailed description and method of attachment
for padded accessories refer to Accessories on page 45.

Base - Seatbelt

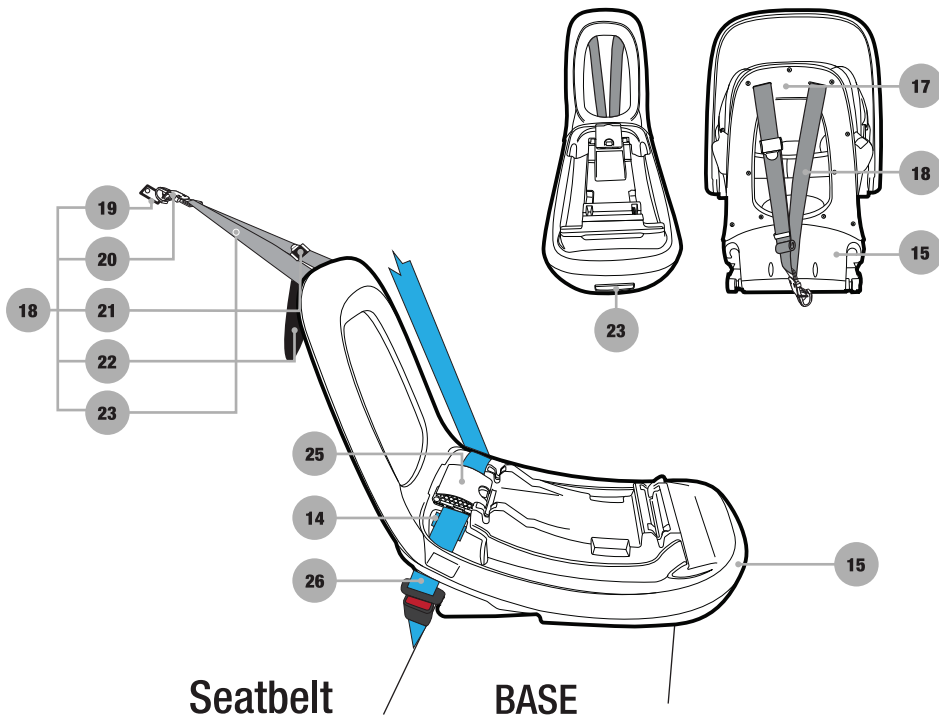

14. "REARWARD-FACING SEAT BELT PATH" Marker (each side of restraint - coloured blue)

15. Base

17. Rebound Bar

18. *Smart Tether*

19. Anchor Fitting + Attachment Hardware

20. Attachment Clip

21. Adjuster

22. Storage Pocket

23. Tether Strap

24. Infant Carrier Release

25. *EasyLock* Belt Clamp

26. Vehicle Seatbelt

Base: ISOFix

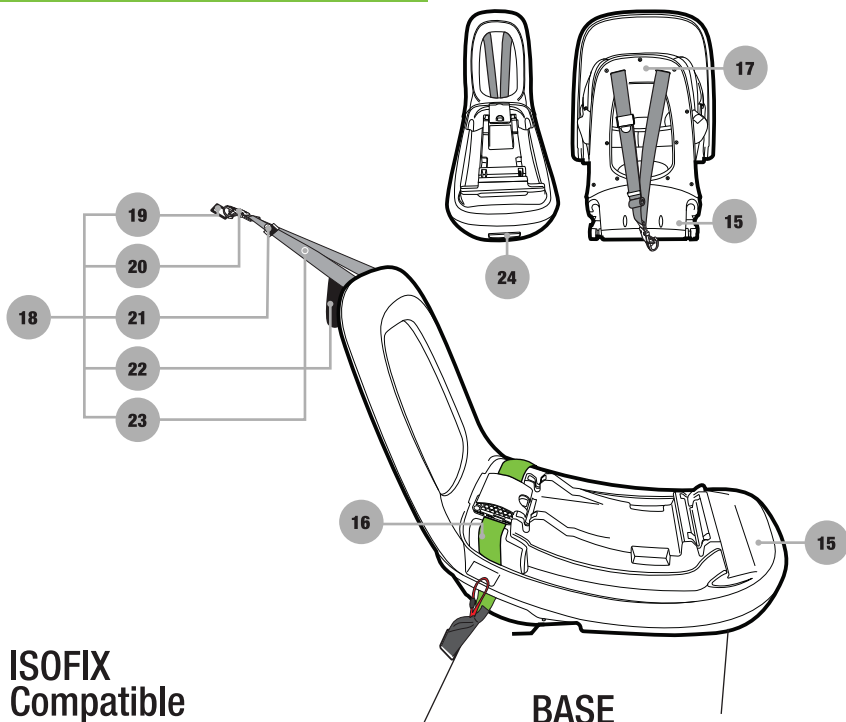

**ISOFIX
Compatible**

BASE

- 15.** Base
- 16.** *ISOFix Compatible*
Lower Attachment Connectors (LAC)
- 17.** Rebound Bar
- 18.** *Smart Tether*
 - 19.** Anchor Fitting + Attachment Hardware
 - 20.** Attachment Clip
 - 21.** Storage Pocket
 - 22.** Adjuster
 - 23.** Tether Strap
- 24.** Infant Carrier Release

Next Type of Restraint

Refer to the 'RESTRAINT GUIDE' for the selection for the most appropriate next restraint (refer page 6). When the child has outgrown the child restraint, then you can use either of the following;

RECOMMENDED

- **Convertible Car Seat - Type (A/B):**
Suitable for approximately 12 months, continue to keep your child rear facing until the shoulders reach the lower shoulder height marker. Then turn to forward facing until the child reaches the upper shoulder height marker - approximately 4 years of age. Some convertible child seats may allow for the child to remain rearward facing until 2 to 3 years of age OR 8 years of age depending on the restraint.

OR

- **Forward Facing Seat - Type (G)**
Suitable for children who have outgrown their baby capsule (approximately 6 months old), up to approximately 4 years of age, or 8 years of age depending on the restraint.

OR

- **Convertible Booster seat - Type (B/E)**
Suitable for children who have out grown their rear facing seat (approximately 6 months old). This seat can be used up to approximately 4 years of age with built-in harness and then be converted to a booster seat and used up to approximately 8 years of age.

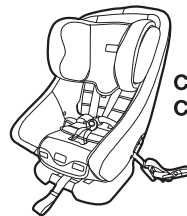

Convertible
Child Seat

Figure 1

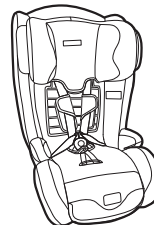

Forward
Facing Seat

Figure 2

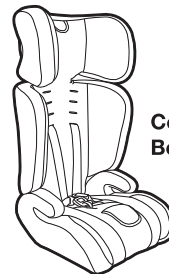

Convertible
Booster Seat

Figure 3

For more information Visit:
www.securesafe.com.au

Information

- The CS2213/CS2313 Infant Carrier has been designed and tested to meet the joint Australian/New Zealand Standard utilising the rebound bar & **Smart Tether** built into the base.

IMPORTANT

- Care and attention should be given to ensure that the baby has adequate ventilation and shading when in the restraint.
- To achieve the necessary distribution of deceleration forces during a vehicle impact, ensure the child is seated correctly in the child restraint and the harness is fitted and adjusted as per these instructions.
- Ensure the child restraint and child are rearward facing.

The Purchaser should check the measurement between the front of the seat back of the rear seat and all front seats in the car in which the child restraint is intended to be used, to ensure that the space is sufficient.

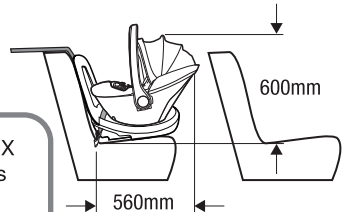

CS2213 Infant Carrier either seatbelt or ISOFIX compatible installations

CS2313 Infant Carrier seatbelt installation only

The CS2213/CS2313 Infant Carrier is suitable for fitting to a variety of strollers.

For compatible strollers refer to www.securesafe.com.au.
Adaptors are required to enable connections to the strollers.

To **RELEASE** carrier from stroller **PRESS** on both sides of the carrier.

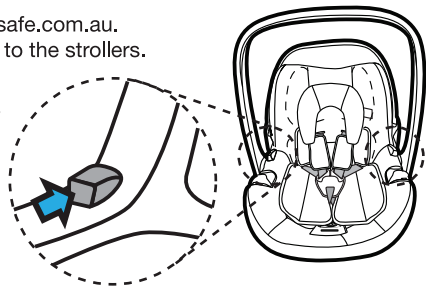

Adjusting the Handle Position

The CS2213/CS2313 Infant Carrier features a sturdy carry handle.

At the base of the handle there are two levers (1 on each side) which control the positions of the handle.

Carry Position

To change the position, depress the large levers on each side of the handle and rotate to the upright position (refer to Figure 1).

When you have started to rotate the handle, release the levers and continue rotating the handle until it locks into position. Ensure the handle is locked in position securely.

Travel Position

To change to the Travel position, depress the large levers on each side of the handle and rotate towards the back of the Infant Carrier (towards the vehicle seat) (refer to Figure 2). When you have started to rotate the handle release the levers and continue rotating the handle until it locks into position. Ensure the handle is locked in position securely.

Non-Rocking Position (Limited Action)

To change the position, depress the large levers on each side of the handle and rotate towards the front of the Infant Carrier (refer to Figure 4). When you have started to rotate the handle release the levers and continue rotating the handle until it locks into position. Care should be taken when passing the handle over the sun hood. Ensure the handle is locked in position securely.

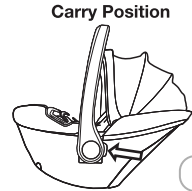

Figure 1

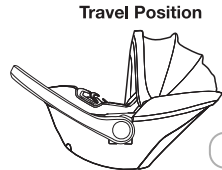

Figure 2

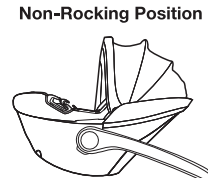

Figure 3



IMPORTANT

- Ensure the handle is locked in position securely
- Ensure the Infant Carrier is placed on a stable surface when carrying out adjustments
- Do not place carrier on a table or a work top where it could fall off

Base

The Base Unit contains the installation method for your vehicle.

| | |
|-----------------------|--|
| CS2213 Infant Carrier | either seatbelt or ISOFIX compatible installations |
| CS2313 Infant Carrier | seatbelt installation only |

You can use either;

Seatbelt Assembly – refer to 'Installing Using Vehicle Seatbelts' (refer to page 21)

or (if your vehicle has the ISOFIX anchorages)

FlexiFix are ISOFIX compatible connectors and indicators for each side of the base. - refer to 'Installing Using **FlexiFix**' (refer to page 26).

IMPORTANT

- Consult the car owner's handbook for the location of the ISOFIX anchorages (if equipped).
- Consult the car owner's handbook for the location of the top tether anchorage points.

If there is no child restraint anchor fitting or child restraint anchor point refer to page 48-49 for the installation of the anchor fitting.

CS2213 Infant Carrier
ISOFIX compatible installations

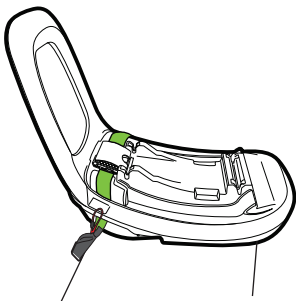

OR

CS2213/CS2313 Infant Carrier
Seatbelt installation

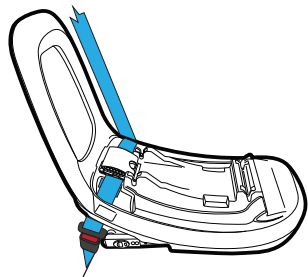

Recline Angle

The vehicle installation is controlled by the angle of the vehicle seat, and these angles vary greatly between vehicles. The vehicle seat angle or the contours of the vehicle seat could place the Infant Carrier either too upright or too recline. A rearward facing restraint should always be installed so that the back surface is reclined just enough to allow the infant's head to lie back comfortably. This measurement is taken when your infant is laying in the Infant Carrier and is in direct contact with this back surface, so it's extremely important to maintain the required angle

IMPORTANT

Your infant should NEVER be too upright or too recline.

TOO UPRIGHT could lead to the infants head flopping forward and potentially pinching off the airway.

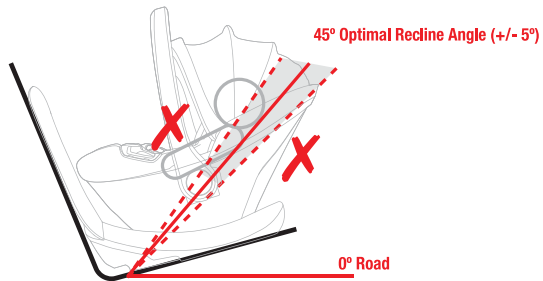

TOO RECLINED could lead to the force to restrain the infant starts to be exceeded by the force to project the infant towards the front of the vehicle (their body wants to slide up towards the top of the shell).

The Base has been provided with a LEVEL INDICATOR LABEL which needs to be level with the road (i.e. parallel with the road surface). This indicates that the installed angle of the Base should be between 10° to 15°.

The LEVEL INDICATOR provides you with the information to determine approximately how reclined (lay back) your infant is in the Infant Carrier. And this needs to be checked to ensure that your infant is not too upright or too reclined.

NOTE: A more accurate method of measuring the recline angle of your infant is to use a smart phone with a application that can measure angles but if using this method ensure the car is on a level surface.

IMPORTANT

Always ensure the rearward angle of the Base is approximately 10° to 15°.

Recline Angle

Base Adjustment

Place the Base and Infant Carrier on the vehicle seat, in a seating position where a child restraint anchor fitting is installed. Check the Level indicator on the Base (refer Figure 1). Adjustment can be achieved by either using the recline foot for more recline, or alternatively the angle could be altered by placing a firm packing between the seat and the underside of the Base (packing can be firmly rolled up towel or nappy).

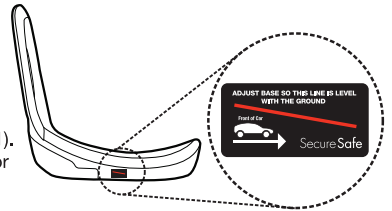

Figure 1

! IMPORTANT

- Always ensure the rearward angle of the Base is approximately 10° to 15°.
- The Line Level Indicator needs to be level with the road

To adjust the Infant Carrier recline angle the following is required;

More Recline (Carrier)

- Step 1:** Take the Base and turn over. At the rear of the Base is a rotating recline foot (refer to Figure 4).
- Step 2:** Hold the recline foot and rotate into the reclined position. (refer to Figure 4).
- Step 3:** The recline foot will lock into position (refer to Figure 4).
- Step 4:** Ready for installation.

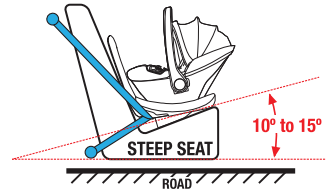

Figure 2

NOTE: If you require more recline place a firm packing between the vehicle seat and the underside of the restraint. We recommend using a TA601 Recline Foam Bar to prop the child restraint, if more recline is required. (Packing could also be achieved by using a firmly rolled up towel).

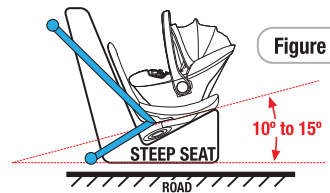

Figure 3

NOTE: Some vehicle seats are steeper than others refer to Figures 2 and 3 for the correct recline.

Positioning the Recline Foot



Flip Recline Foot

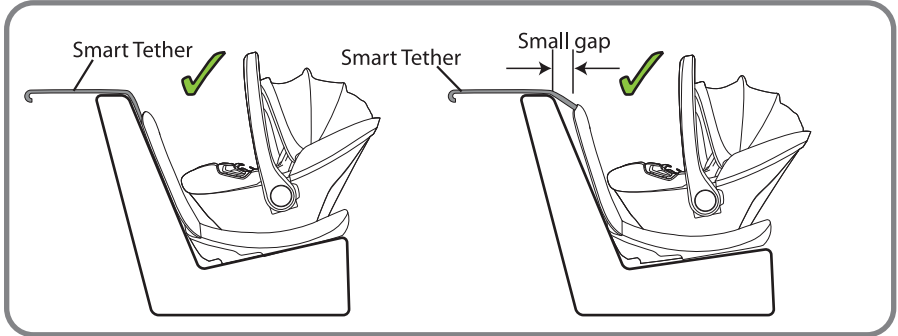

Figure 4

Recline Angle

Base Adjustment

NOTE: Smart Tether & Rebound Bar doesn't need to be in total contact with the car's seat back.



Installing Base Using Vehicle Seatbelts

An anchor fitting is required to attach the **Smart Tether** and to complete the installation of the Infant Carrier into your vehicle (refer page 24).



IMPORTANT

- Consult the car owner's handbook for the location of the top tether anchorage points. If there is no child restraint anchor fitting or child restraint anchor point refer to page 49-50 for the installation of the anchor fitting.

- Step 1:** Locate the Top Tether anchorages points.
- Step 2:** Place the Base in the seating position (refer Figure 1).
- Step 3:** Check and Verify that the base angle is as required, otherwise adjust as shown (refer page 19).
- Step 4:** Open **EasyLock** (belt clamp) (refer Figure 2 & 3).
- Step 5:** Extend the seat belt to maximum length.



IMPORTANT

Ensure that you use the **REARWARD-FACING BELT PATH** identified by the following label.



For a lap/sash seatbelt, position the tongue in the middle of the fully extended belt.

- Step 6:** Feed the adult lap or lap/sash belt through the belt path opening on each side of the Base (refer Figure 4 & 5).
- Step 7:** Engage the buckle and tongue assembly (listen for the "CLICK"). Check the buckle engagement with a gentle pull.

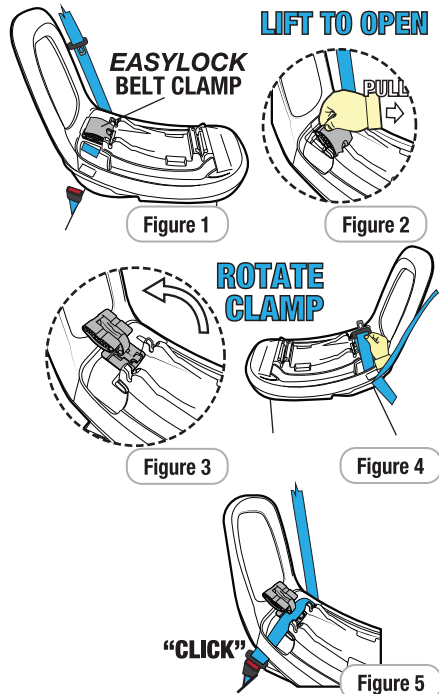

Installing Base Using Vehicle Seatbelts

Step 8: Ensure the seatbelt is routed as per Figure 6.

Step 9: Push down on the Base (with knee or hand) whilst pulling the sash section of the vehicle belt firmly in direction of the blue arrow in Figure 7.
(This will tighten the lap belt across the Base).

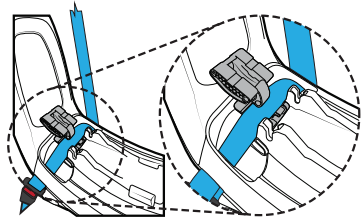

Figure 6

Step 10: Ensure the excess slack in the sash belt is removed by feeding back towards the seat belt retractor (refer Figure 7).

Step 11: Fold & Lock **EasyLock** (belt clamp), the base is now ready for use (refer Figure 8).



IMPORTANT

- ENSURE SEATBELT IS UNDER CLAMP
- ENSURE ALL SLACK IS REMOVED FROM SEATBELT
- ENSURE SLACK IS NOT CREATED IN SEATBELT.

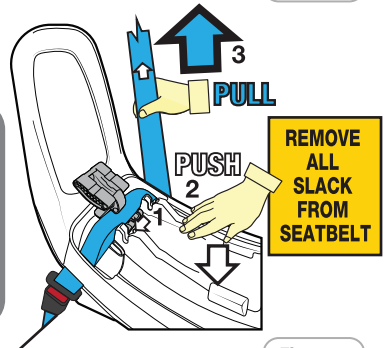

Figure 7

ALTERNATIVELY LAP ONLY INSTALLATION

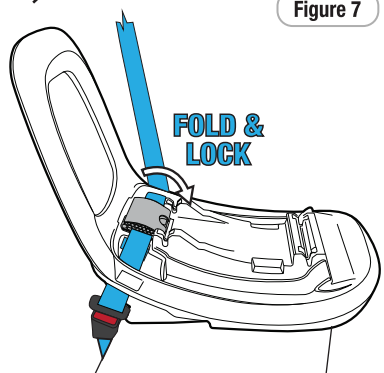
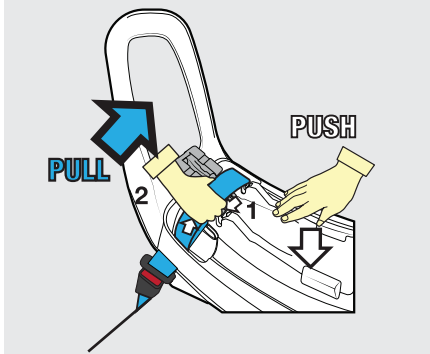

Figure 8

Top Tether Strap

Step 1: Consult the car owner's handbook for the location of the top tether anchorage points. If an extension strap is required then refer to Extension Straps on page 44. An anchor fitting is required to attach the top tether strap and to complete the installation of the Infant Carrier into your vehicle.

The Infant Carrier is supplied with a **Smart Tether** (top tether strap) attached to the rebound bar on the base unit.



IMPORTANT

- Consult the car owner's handbook for the location of the top tether anchorage points.

If there is no child restraint anchor fitting or child restraint anchor point refer to Page 48-49 for the installation of the anchor fitting.

THIS RESTRAINT IS NOT SUITABLE FOR USE WHERE THE TOP TETHER STRAP MAY FALL INTO A SPLIT IN THE SEAT BACK OR OFF THE SIDE OF THE SEAT.



CAUTION

• CHILDREN CAN BE INJURED OR RESTRAINTS AND TOP TETHER STRAP DAMAGED BY UNSECURED CARGO IN A COLLISION. SECURE OR REMOVE HAZARDOUS CARGO BEFORE USING THIS CHILD RESTRAINT.

- Always secure the loose end of the top tether strap to prevent it hanging out of the car or being accessible by the child.

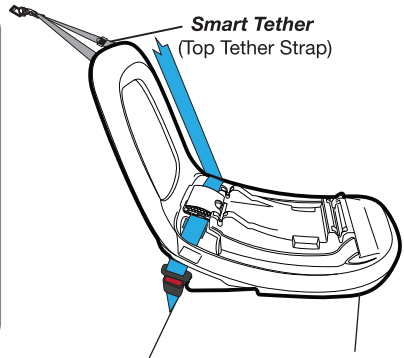

THIS RESTRAINT MUST BE ATTACHED TO A CHILD RESTRAINT UPPER ANCHORAGE POINT IN THE CAR. REFER TO CAR OWNERS HANDBOOK FOR UPPER ANCHORAGE POINTS. REFER TO A CHILD RESTRAINT FITTING STATION IF NO UPPER ANCHORAGE ARE IN THE MOTOR CAR.

Top Tether Strap

NOTE: Smart Tether (top tether strap) is attached to the rebound bar on the base.

- Step 1:** Lengthen the **Smart Tether** (top tether strap), tilt the adjuster and pull the strap.
- Step 2:** Attach the **Smart Tether** (top tether strap) to the vehicle's Upper Anchor Fitting (refer Figure 1).
- Step 3:** Tighten the **Smart Tether** (top tether strap) to achieve a firm installation.



IMPORTANT

- Always use top tether strap.
- Always secure the loose end of the top tether strap to prevent it hanging out of the car or being accessible by the child.

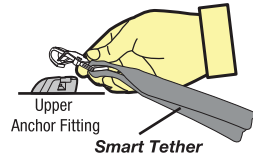
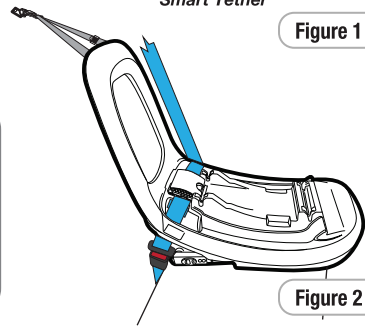
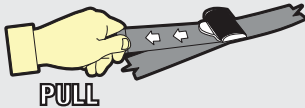

Figure 1



To Tighten



To Lengthen

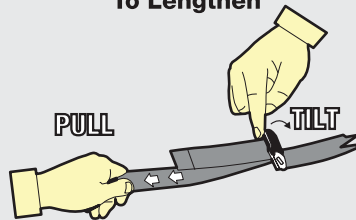

Tether Storage

Store any excess webbing, from the top tether strap, in the storage pocket provided located on the rebound bar of the base (refer Figure 3).

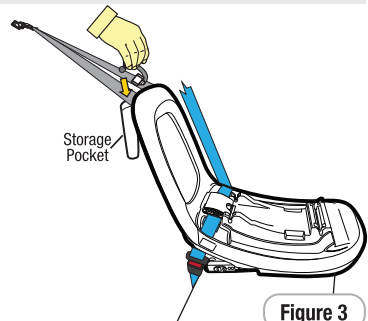

ISOFIX Lower Anchorages

Newer vehicles have one or more seating positions with ISOFIX anchorages. If the vehicle is equipped with ISOFIX anchorage, the lower anchor points may be visible at the vehicle seat bight . If not visible, they may be marked with this symbol.



ISOFIX



See your vehicle owner's manual for exact locations, anchor identification, and requirements for use with a child restraint.

Check vehicle owner's manual for vehicle top tether anchor locations. They may be identified using one of the anchor symbols as shown.



IMPORTANT

ONLY use Lower Anchorage Connectors on the child restraint in a seating position recommended by vehicle manufacturer.

This restraint uses Flexible Lower Anchorage Connector Straps (LAC).

Flexible connectors: A pair of flexible straps with connectors are located at the base of the child restraint which connect to the vehicle's ISOFIX low anchorages. The flexible connectors are then adjusted to secure the child restraint firmly to the vehicle. The top tether strap must be anchored to the vehicle. The vehicle seatbelt will not be required when the flexible connectors are being used.

ISOFIX low anchorages are built in to the vehicle at the time of manufacture, if the vehicle manufacturer chooses to provide them. The number of ISOFIX low anchorages will depend on the design of the vehicle. Generally, ISOFIX low anchorages are located on the two outer seating positions in the second row, and not in the middle seating position. If you wish to use the middle seating position in the second row, you may still fit an ISOFIX compatible child restraint in the middle position by using the vehicle seatbelt and top tether strap.

CS2213 MODEL ONLY

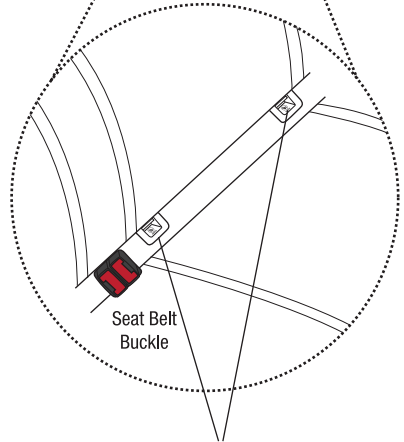
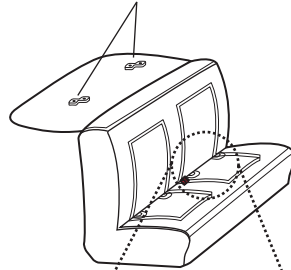

ISOFIX



Installing Base using flexible ISOFIX Lower Anchorage Connectors (LAC) (CS2213 MODEL ONLY)



IMPORTANT

- Consult the car owner's handbook for the location of the ISOFIX anchorages
 - Consult the car owner's handbook for the location of the top tether anchorage points.
- If there is no child restraint anchor fitting or child restraint anchor point refer to page 46-47 for the installation of the anchor fitting.

Step 1: Locate the ISOFIX compatible and Top Tether anchorage points in your car (refer to owners manual).

Step 2: Remove the carrier from the base by pressing the release lever (refer Figure 1).

Step 3: Turn the base over. The flexible ISOFIX compatible lower anchorage connectors (LAC) are stored under the base (refer Figure 2).

Step 4: Pull the "RED" release straps to unclip the connectors and release straps from under the base (refer Figure's 3 & 4).

Step 5: Ensure the flexible ISOFIX compatible lower anchorage connector (LAC) straps are routed, from locking clamp down through the seat belt path openings and directly towards anchorage point (refer Figure 4).

Step 6: Place the base in the seating position (refer Figure 6 & 7) and fully lengthen the flexible ISOFIX compatible Lower Anchorage Connectors (LAC).

NOTE:

It may be easier to use the lengthened LAC straps, and move the Base away from the seat back to give better access to the ISOFIX anchors (refer Page 27).



Figure 1

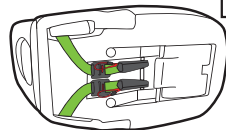

Figure 2

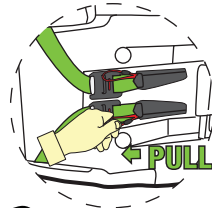

Figure 3

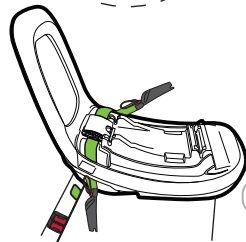

Figure 4

ISOFIX Compatible Restraint

Infant Seat
Rearward Facing

Installing Base using flexible ISOFIX Lower Anchorage Connectors (LAC) (CS2213 MODEL ONLY)

Step 7: Take the flexible ISOFIX compatible lower anchorage connectors (LAC) and insert the connectors between the seat cushion & seat back, at the locations marked with the ISOFIX identifications (check the vehicle owners manual for exact locations)

Step 8: Push down on the Base (with knee or hand) whilst pulling the adjuster strap firmly. Remove all slack from the LAC straps by pulling the adjuster strap firmly. The **GREEN** indicator is activated (refer Figure 6). Repeat for both side of the Base.

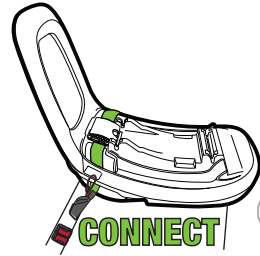

Figure 5

IMPORTANT

- The purchaser should check the measurements between the front of the seat back of the rear seat and all front seats in the car in which the child restraint is intended to be used, to ensure that the space is sufficient.
- Care and attention should be given to sufficient ventilation and shading of the baby. Always secure the loose end of the top tether strap to prevent it hanging out of the car or being accessible by the child.

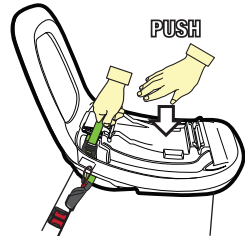

Figure 6

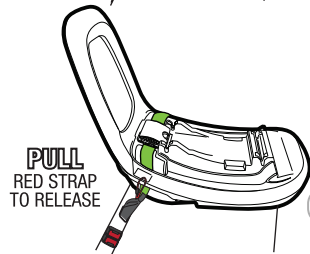
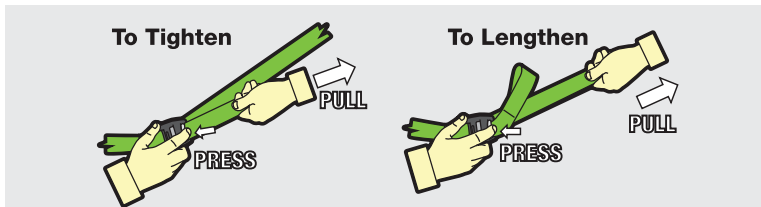

Figure 7

Step 9: To release the LAC straps from vehicle 'PULL' the red strap to detach from anchorage point and store in the compartment beneath the seat (refer Figure 7).



Installing Base using flexible ISOFIX Lower Anchorage Connectors (LAC) (CS2213 MODEL ONLY)

Step 1: Consult the car owner's handbook for the location of the top tether anchorage points. If an extension strap is required then refer to Extension Straps on page 44. An anchor fitting is required to attach the top tether strap and to complete the installation of the Infant Carrier into your vehicle.

The Infant Carrier is supplied with a **Smart Tether** (top tether strap) attached to the rebound bar of the base unit.

IMPORTANT

- Consult the car owner's handbook for the location of the top tether anchorage points.

If there is no child restraint anchor fitting or child restraint anchor point refer to Page 48-49 for the installation of the anchor fitting.

THIS RESTRAINT IS NOT SUITABLE FOR USE WHERE THE TOP TETHER STRAP MAY FALL INTO A SPLIT IN THE SEAT BACK OR OFF THE SIDE OF THE SEAT.

CAUTION

• CHILDREN CAN BE INJURED OR RESTRAINTS AND TOP TETHER STRAP DAMAGED BY UNSECURED CARGO IN A COLLISION. SECURE OR REMOVE HAZARDOUS CARGO BEFORE USING THIS CHILD RESTRAINT.

- Always secure the loose end of the top tether strap to prevent it hanging out of the car or being accessible by the child.

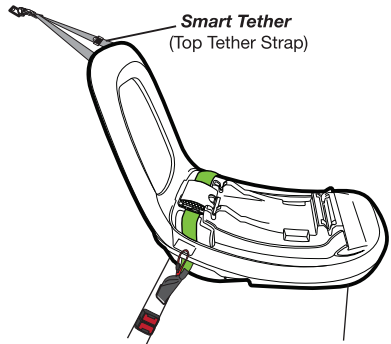

THIS RESTRAINT MUST BE ATTACHED TO A CHILD RESTRAINT UPPER ANCHORAGE POINT IN THE CAR. REFER TO CAR OWNERS HANDBOOK FOR UPPER ANCHORAGE POINTS. REFER TO A CHILD RESTRAINT FITTING STATION IF NO UPPER ANCHORAGE ARE IN THE MOTOR CAR.

Smart Tether (Top Tether Strap)

NOTE: Smart Tether (Top Tether Strap) is attached to the rebound bar on the base.

- Step 1:** Lengthen the **Smart Tether** (Top Tether Strap), tilt the adjuster and pull the strap.
- Step 2:** Attach the Top Tether Strap to the vehicles Upper Anchor Fitting (refer Figure 1).
- Step 3:** Tighten the Top Tether Strap to achieve a firm installation.



IMPORTANT

- Always use top tether strap.
- Always secure the loose end of the top tether strap to prevent it hanging out of the car or being accessible by the child.

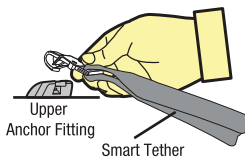
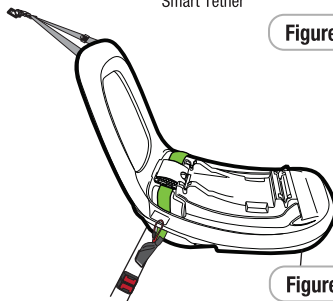
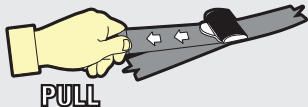

Figure 1



To Tighten



To Lengthen

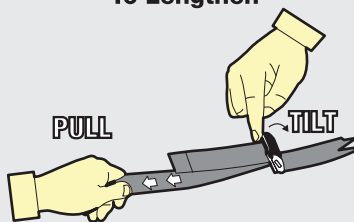

Tether Storage

Store any excess webbing, from the top tether strap, in the storage pocket provided located on the rebound bar of the base (refer Figure 3).

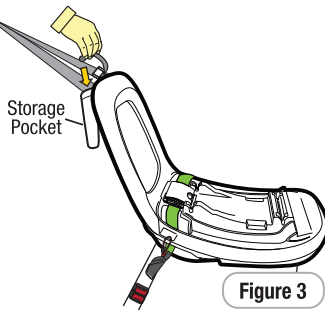

Infant Carrier

The Infant Carrier is supplied with the internal harness set-up in the lowest shoulder slot height. SecureSafe recommend that you use the infant insert and pillow for a small new born.

NOTE: Discontinue to use the padded insert and pillow, if the continued use causes overheating, discomfort or you require room for the infant to grow.

For new born or infants with breathing difficulties or medical concerns, SecureSafe recommend that you seek medical advice before you travel.

This section covers the setting up of the Infant Carrier in preparation for travelling.

The Infant Carrier is fitted with three shoulder strap slot positions. As the infant grows the shoulder straps must be moved to the next higher slots.

Correct Slot Height

The correct height for the shoulder straps is very important for the optimum performance of the restraint.

! IMPORTANT

The shoulder straps must be in the slots which are nearest to the child's shoulders, but not lower than the child's shoulders.

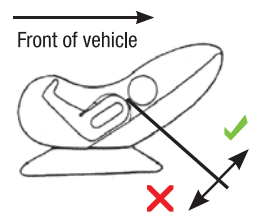

Figure 1

With the child correctly sitting in the restraint, check which set of slots (In the plastic shell of the restraint) are level with or just above the infant's shoulders.

If the harness straps are located in those slots, then the you can proceed with using the restraint (see section "USE" on page 33). If not then adjust the shoulder straps.

Slot Position

Nearest to the child's shoulders but not lower.

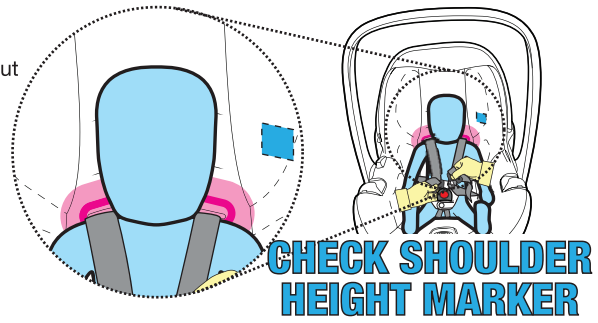

Infant Carrier

Adjusting Shoulder Strap Height

- Step 1:** To loosen the harness straps, Press the harness adjuster whilst pulling on both harness straps (refer Figure 2). Loosening the harness will allow the spreader plate to rise from under the restraint.
- Step 2:** Turn the restraint around so that the back of the seat is facing you. Remove each shoulder harness through the gates in the spreader plate (refer Figure 3 & 7).
- Step 3:** Pull the harness shoulder straps through the shoulder slot holes in the seat shell and cover. They should now be loose in the front of the seat (refer Figure 4).

NOTE: A new born or very small infant will require the installation and use of the infant insert and pillow to ensure correct fitment.



IMPORTANT

The shoulder straps must be in the slots which are nearest to the infant's shoulders, but not lower than the infants shoulders.

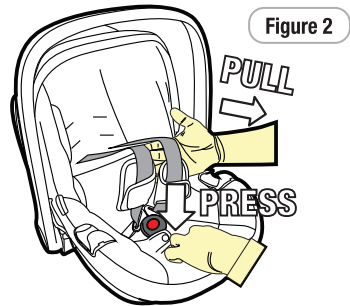

Figure 2

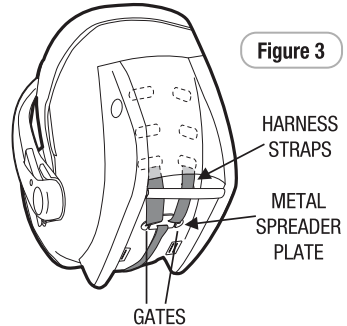

Figure 3

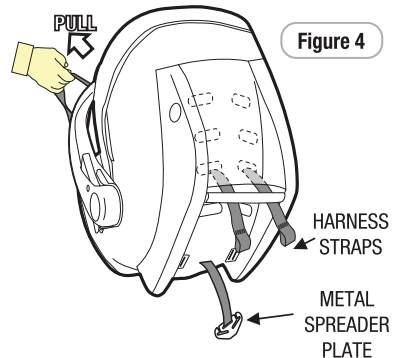
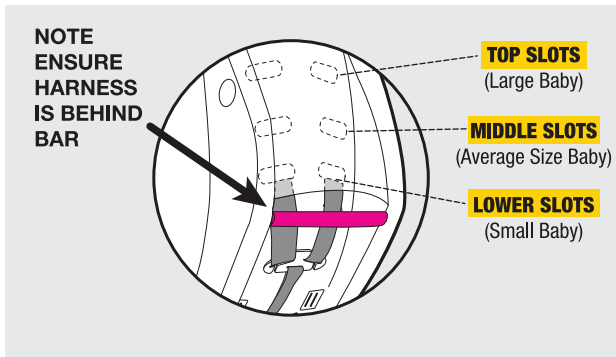

Figure 4

Infant Carrier

Adjusting Shoulder Strap Height

Step 4: Push the ends of the harness shoulder straps through the appropriate shoulder slot holes in the cover and seat shell for the child's correct shoulder height (refer Figure 5).



! IMPORTANT
ENSURE HARNESS IS BEHIND BAR.

Step 5: The harness shoulder straps go directly from the shoulder slot holes to the spreader plate. Thread each shoulder harness strap back onto the metal spreader plate through the gates (see Figures 6 & 7).

NOTE: Ensure the harness straps are not twisted.

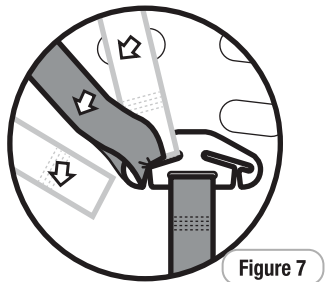
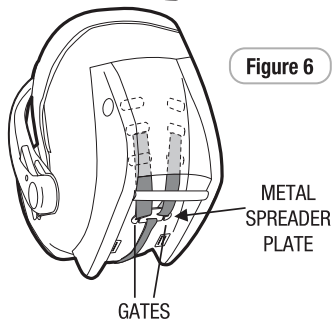
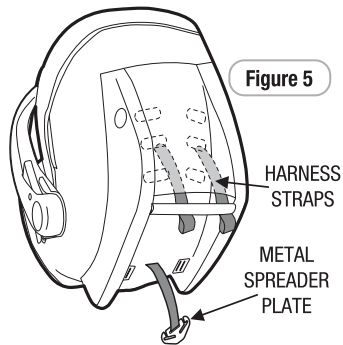

Buckle Height Adjustment

The buckle is supplied in POSITION 1 (new born).

- Step 1:** Lift the buckle and determine whether POSITION 1 (new born) or POSITION 2 (larger child), so it's more appropriate for your baby. (refer Figure 1).
- Step 2:** To alter the buckle position, turn the carrier up side down and grab the 3 bar plate and feed it through the slot (refer Figure 2).
- Step 3:** Buckle should now be in POSITION 2 (refer Figure 3).

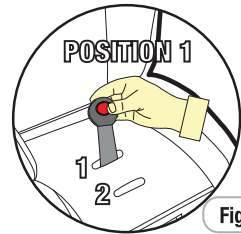

Figure 1

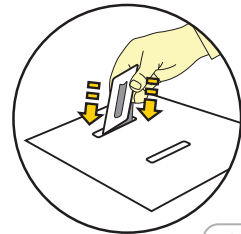

Figure 2

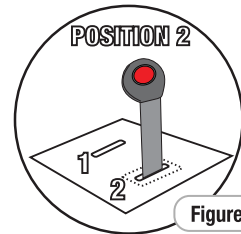

Figure 3



IMPORTANT

KEEP BUCKLE LOW AS POSSIBLE

Always ensure buckle has clearance from the upper thighs (see indicated area Figure 4).

Note: When using the buckle ensure that the buckle tongues have clearance above the upper thighs (refer Figure 4).

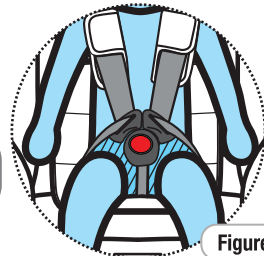
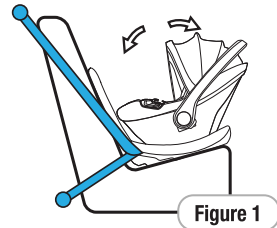
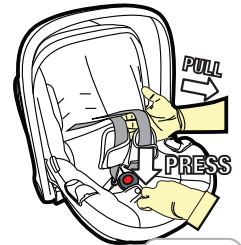
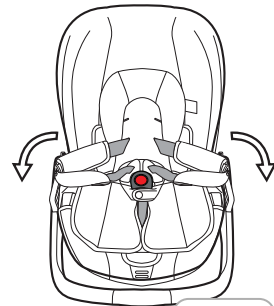

Figure 4

Using Harness

- Step 1:** Place the Infant Carrier on a flat surface or alternatively whilst the carrier is still in the car.
- Step 2:** Ensure the carry handle is folded out of the way and the Hood is fully opened, to enable complete access to the seat (refer Figure 1).
- Step 3:** Loosen the harness straps by pressing the harness adjuster whilst pulling on both harness straps (Refer Figure 2).
- Step 4:** Release the buckle
- Step 5:** Lay the two harness straps (with tongues) to the sides of the Infant Carrier (refer Figure 3).
- Step 6:** Place the infant into the Infant Carrier, flat on their back, with the buckle positioned between the infant's legs. Ensure the infants arms and legs are free.
- Step 7:** Check to determine whether the harness shoulder straps are in the correct shoulder slot height (refer to sections 'Correct Slot Height' and 'Adjusting Shoulder Strap Height' on page 29). Adjust as required.

Figure 1

Figure 2

Figure 3

IMPORTANT

- Do not harness an infant wrapped in a blanket or swaddled as this increases the risk of ejection and injury or death in a crash.
- The harness needs to fit firmly to the infant, any blanket or other covering may be placed over the harness after the harness is correctly adjusted.
- Arms and legs must be free and not bound or wrapped together.
- The legs must sit on each side of the buckle
- Always remove the infant from the Infant Carrier prior to adjusting shoulder heights.

NOTE: Discontinue using the insert when the insert is a tight fit or creates discomfort for larger babies/children.

Using Harness

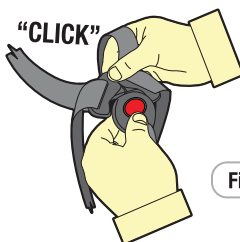
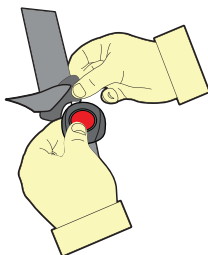
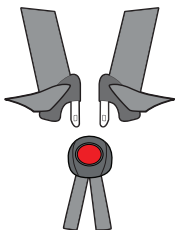

Figure 5

Step 8: Insert either tongue into the buckle followed by the other tongue until a **“CLICK”** is heard. Should the second tongue not insert, press the red button and reinsert the tongues. Ensure secure engagement by pulling the harness strap (refer Figure 5).

**IMPORTANT**

If no “Click” can be heard or a secure engagement cannot be achieved refer to Cleaning Buckle Harness page 43.

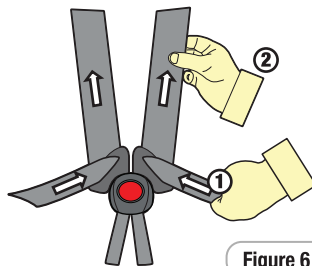

Figure 6

Step 9: Remove all of the slack for the harness lap straps by pulling shoulder straps (refer Figure 6), then pull the harness adjustment strap to adjust harness to a comfortable but firm fit (refer Figure 7).

**WARNINGS**

- **DO NOT LEAVE CHILDREN UNATTENDED IN THE CAR.**
- Fit the harness firmly to the child.
- **A LOOSE RESTRAINT OR HARNESS IS DANGEROUS.**

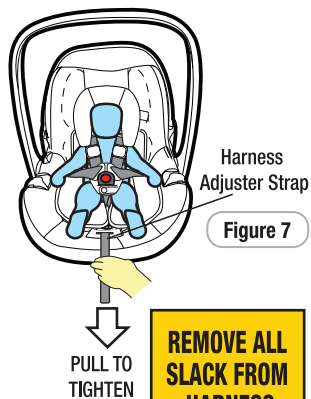

Figure 7

PULL TO
TIGHTEN

**REMOVE ALL
SLACK FROM
HARNESS**

Using Harness

**IMPORTANT**

- **A LOOSE HARNESS IS DANGEROUS.**
- The Padded Insert/s (if fitted) are designed to provide extra support and comfort for small babies. Discontinue use when the insert is a tight fit or creates discomfort for larger babies/children.
- Always adjust the height of the shoulder straps as the child grows.

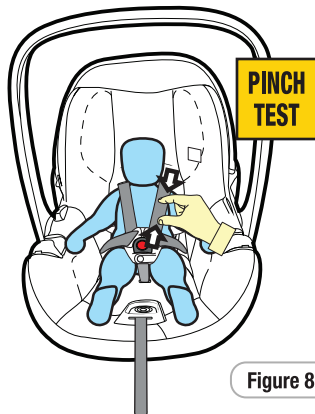

Figure 8

Step 10: Check the harness tightness by the **PINCH TEST**, this is achieved by pinching the harness webbing at the shoulders (refer Figure 8)

- If you can pinch the harness strap, tighten more.
- If your fingers slip off, then the harness is tight enough.

**WARNINGS**

- **DO NOT LEAVE CHILDREN UNATTENDED IN THE CAR.**

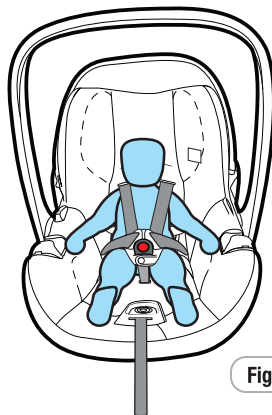

Figure 9

Carrier into Base

Step 1: Lift the Infant Carrier by the carry handle and position over the top of the Base (refer Figure 1) (Ensure that the adjuster strap doesn't get caught between the Infant Carrier and Base).

Place the back heel of the Infant Carrier into the Base first ①,

Step 2: securing hooks on the Base ② (refer Figure 2),

Step 3: Press down on the Infant Carrier to engage the securing hooks. Pull upwards on the Infant Carrier to check it is correctly locked into position (refer Figure 3),

Step 4: Ensure the Carry Handle is rotated in the 'TRAVEL' position refer to 'Adjusting the Handle Position' page 16.

**WARNING**

- Always use a lap or lap-sash seat belt and top tether strap to attach the child restraint to the vehicle.
- Do not use the restraint without the top tether strap correctly attached and adjusted.
- Do not use on any vehicle seat which faces sideways or rearwards.
- IF AN AIRBAG IS FITTED IN THE SEATING POSITION WHERE THE CHILD RESTRAINT IS TO BE FITTED, FOLLOW THE VEHICLE MANUFACTURER'S WARNINGS AND INSTRUCTIONS.

- Do not use the restraint if the buckle is sluggish or does not provide an audible "Click" refer to Cleaning Instructions on page 43.

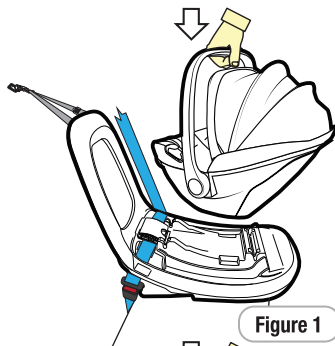

Figure 1

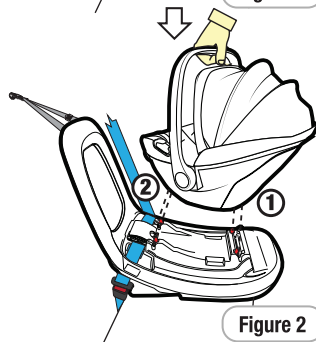

Figure 2

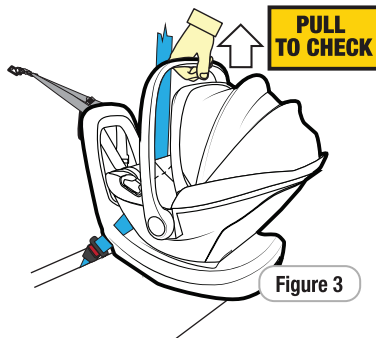

Figure 3

Carrier from Base

Step 1: Rotate the Carry Handle to the 'Carry Position' (refer Figure 1 on page 16).

Step 2: 'Squeeze' the release then lift the Infant Carrier clear of the Base, and with care remove from the vehicle (refer Figure 1 & 2).



WARNINGS

- **DO NOT LEAVE CHILDREN UNATTENDED IN THE CAR.**
- Fit the harness firmly to the child.
- **A LOOSE RESTRAINT OR HARNESS IS DANGEROUS.**

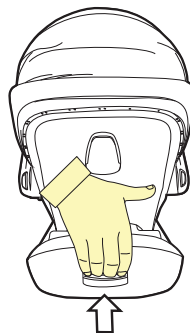

Figure 1

**SQUEEZE
TO RELEASE
CARRIER**

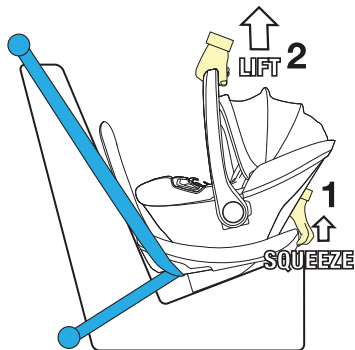

Figure 2

Removing Infant from Infant Carrier

- Step 1:** Place the Infant Carrier on a flat and secure surface.
- Step 2:** Rotate the Carry Handle to the 'Non –Rocking Position' (refer to page 16) and the Hood is fully opened, to enable complete access to the seat (refer Figure 1).
- Step 3:** Loosen the harness straps by pressing the harness adjuster whilst pulling on both harness straps (refer Figure 2).
- Step 4:** Release the buckle (refer Figure 3).
- Step 5:** Lay the two harness straps (with tongues) to the sides of the Infant Carrier.
- Step 6:** Feed the infant's arms through each of the harness straps and lift the infant out of the Infant Carrier.

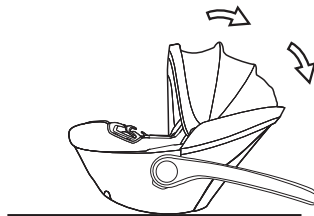

Figure 1

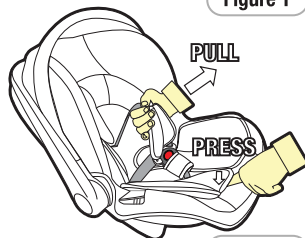

Figure 2

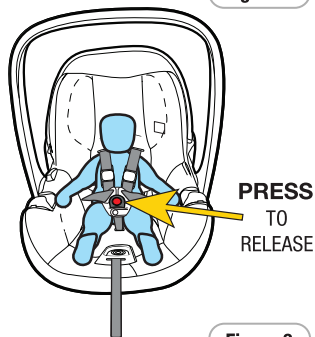

Figure 3

How to Install into the Aircraft

The Infant Carrier without base is suitable for use on aircraft. The Infant Carrier must be used in accordance with the aircraft operators procedures, and any directions from the aircraft operator, pilot or crew.

The Infant Carrier may not fit in smaller aircraft. Inform the aircraft operator that a child restraint is intended to be used on the aircraft when booking the flight as the child restraint may not be suitable for use in that operator's specific aircraft.

Follow the instructions of the flight crew or pilot.

For use of the child restraint in cars in countries other than Australia and New Zealand, the user should consult the country's local authorities, car hire companies, car insurance companies, etc. for advice. The child restraint may not be acceptable for use in all cars.

Fit The Infant Carrier to the Aircraft Seat

You do not need the base and we recommend that you check it in with your luggage.

- Step 1:** Position the infant carrier rearward facing. If possible, lift the armrests out of the way to improve access to installing the aircraft lap belt and to suit the width of the carrier.
- Step 2:** Place handle in "carry" position (fully upright).
- Step 3:** Fold back the sides of the seat cover to expose the aircraft seatbelt path.

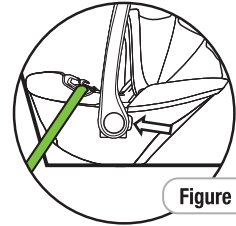

Figure 1



IMPORTANT

Ensure that you use the **AIRCRAFT SEATBELT PATH** identified by the following label.

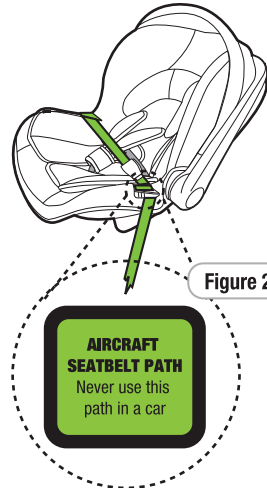

Figure 2

Fit the Infant Carrier to the Aircraft Seat

Step 4: Fully lengthen lap belt.

Thread the lap belt into **AIRCRAFT SEATBELT PATH** lap belt path (green marker), ensuring that lap part is below the hook as shown on each side (refer Figure 1 & 2).



IMPORTANT

- Do not use the restraint with aircraft seatbelts that contain airbags unless the aircraft operator has a method to disable the airbag.
- Lengthen the seatbelt or use an extension seatbelt to reposition the buckle to the side of the child restraint.
- Never use this path in a car

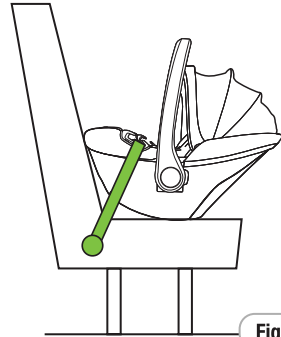

Figure 3

Step 5: Engage lap belt buckle and tongue. Push down on the infant carrier and remove all slack from the lap belt. Pull belt strap to tighten, ensure a firm fit of the infant carrier to the seat.

The infant carrier base may be included with 'checked in' luggage (for use after flight). Aircraft label is located on the underneath of the infant carrier. It demonstrates suitability for use on aircraft.



This Child Restraint System meets the standards for use in aircraft as recommended by the Civil Aviation Safety Authority of Australia and the Civil Aviation Authority of New Zealand.

Only to be used on aircraft with the permission of the aircraft operator, pilot and crew,
SUITABLE FOR REAR FACING USE

The top tether strap is not required to be used onboard aircraft and should be stowed securely.

Care of Restraint

The child restraint cover has been manufactured to meet the Australian Standards requirements for flammability and toxicity to ensure your child's safety. The cover has also been designed to provide your child with comfort and support.

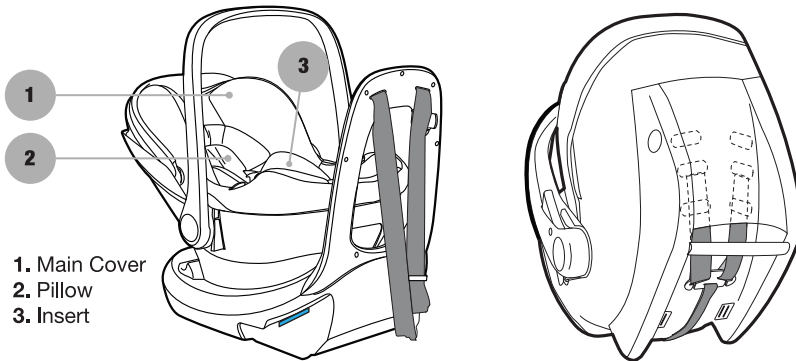

VERY IMPORTANT

Only replace the cover with a SecureSafe supplied replacement cover with identical shoulder height markers or a replacement cover meeting AS/NZS 8005.

Care and Maintenance

Regular care of the restraint will ensure safety of your child.

- Check the webbing for fraying.
- Check the upper anchorage attachment clip to ensure retainer clip is still present.
- Ensure there are no cracks in the plastic mouldings.
- Check the buckles “click” when you engage tongues and is not sluggish or sticky in operation.
- Ensure the buckle is free of fluff, liquid, or other matter that may enter the buckle slots. Clean the buckle if it is sluggish to engage (refer Cleaning Buckle page 43)
- Check the harness adjuster is operating and is clamping the webbing
- If any part of the restraint is cracked or broken, seek repair immediately or replace the child restraint.

Cleaning



IMPORTANT

Use only mild soap and water to clean all parts of the CS2213/CS2313 Convertible Car Seat.
Do not use chemicals or cleaning agents
Cold water only to be used and to be rinsed well
Do not dry clean or tumble dry
Do not bleach.

Covers

The restraint has a flame retardant cover which is removable for cleaning. Cleaning instructions are on the care label attached to the cover. If a fluffy cover is fitted, then washing the cover prior to use will remove excess fluff.

The cover has been designed to protect your child when seated in the restraint. Care should be taken, if children either eat or drink while in the restraint, as some food or drink products may cause damage or marking to the cover. Wash or clean immediately. Do not pull sticky items from covers as the cover may be damaged - soak in water and gently remove.

Only machine wash on gentle cycle (hand washing is recommended). When washing the covers, ensure the hook and loop attachment strips are connected to eliminate other materials or garments being caught. Ensure that the hook and loop attachment strips are free of lint, this will ensure a positive engagement.



IMPORTANT

For **Leatherette** fabric only sponge clean with a damp cloth.

Seat + Hardware

Use only mild soap and water to clean all webbing, metal and plastic parts of the restraint using a damp cloth.
Do not use chemicals or cleaning agents.

Harness Straps

Use only mild soap and water to clean all straps, using a damp cloth the harness straps can be soaked, however they must be thoroughly dried without excessive heat (never tumble dry). The harness straps should not be placed in a washing machine as this may cause damage to the stitching or even damage your washing machine.
Do not use chemicals or cleaning agents.

Cleaning

Harness Buckle

If sticky liquids such as baby formula, fruit juice, etc. get inside your Harness Buckle, it may become sluggish. An indication of a sluggish Harness Buckle is that you cannot hear a “CLICK” when engaging the Harness Tongues. To restore the Harness Buckle to good working order it needs to be cleaned as follows:

Step 1: From the underside of the restraint pull each crotch 3-bar slide then turn 3-bar slide and push through each slot to remove the Harness Buckle from the restraint (refer Figure 1).

Step 2: Place the Harness Buckle under warm (max. 40 degrees Celsius) running water as shown below. Let the water run through the mouth of the buckle for five minutes (refer Figure 2).

Step 3: Engage and disengage the Harness Tongues and Buckles several times until a strong audible “CLICK” is heard when inserting the last tongue (refer Figure 3).

Step 4: If you still cannot hear a strong audible click after engaging the Harness Tongues and Buckle, then repeat cleaning several times. If the Harness Buckle cannot be returned to its original working condition then contact SecureSafe Customer Care:
AU: 1300 92 4632 NZ: 067 590 870

Step 5: Refit the harness buckle to the restraint with the red button facing out and feeding each 3-bar slide through appropriate slot. Always ensure the webbing crotch straps are thoroughly dried before installing.

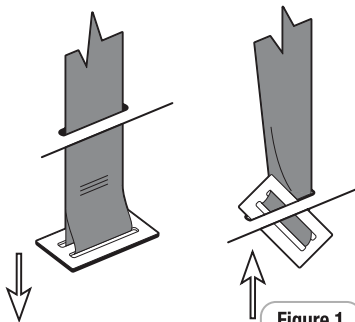

Figure 1

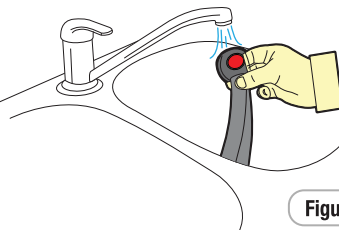

Figure 2



Harness Buckle Care

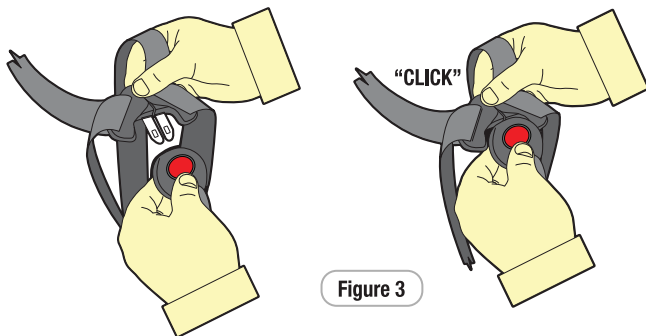

Figure 3

Remove & Replace Covers

Main Cover

Step 1: Remove harness straps (refer Adjusting Shoulder Strap Height, pages 29 - 31).

Step 2: Remove Cover.

- Ensure Pillow, Insert & Pads are removed.
- Pull the elasticated section from around the plastic AIRCRAFT path
- Pull the elasticated section from around the adjuster covering.
- The main cover should now be removable from the snug fit on the seat shell.

Step 3: *Replace Cover in reverse.



Figure 1

Extension Straps

If required contact SecureSafe for nearest supply location. Extension straps, not included in this package, may be required for vehicles without a fixed parcel shelf.

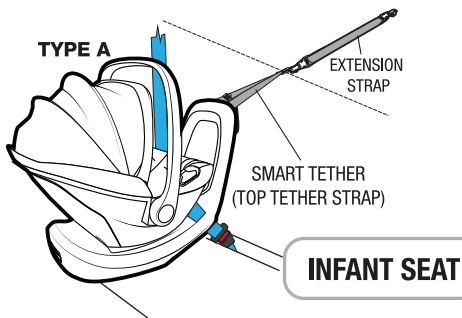

Re order Line Numbers

| | |
|-------|------------------------------------|
| CS111 | 300mm Length |
| CS112 | 600mm Length |
| CS113 | 200mm - 900mm Adjustable Length |

If required contact SecureSafe
Customer Care 1300 92 4632 (AU)
or 067 590 870 (NZ) for nearest
supply location.

Accessories

Follow the instructions covering the use of accessories either provided with this child restraint or sold as separate accessories or spare parts provided by SecureSafe for this restraint.

IMPORTANT

Use of unauthorised aftermarket accessories (i.e items not provided in this box with the child restraint), can reduce the safety provided by the child restraint and may cause injury or death.

Accessories provided by SecureSafe for CS2213/CS2313 comply with all the requirements with AS/NZS 1754:2013.

PADDED INSERTS (if fitted)

The padded inserts are designed to add extra comfort for your child.

- Step 1:** Place insert into infant carrier
- Ensure lap sections are routed via side cutouts.
 - Ensure insert is positioned below the shoulder slots.

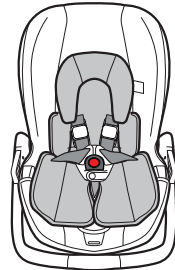

INFANT PILLOW (if fitted)

Infant pillow (if fitted) is designed to provide extra comfort.

- Step 1:** To attach pillow, press stud behind the insert.

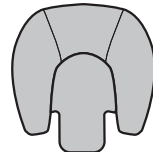
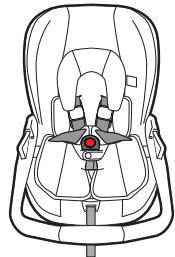

Accessories

SHOULDER PADS (if fitted)

The shoulder pad is designed to add extra comfort for baby or child.

Alternative Pads

Step 1: Separate press-studs and remove the shoulder pads from harness

Step 2: To attach shoulder pads, ensure press studs face away from the child and re-attach.

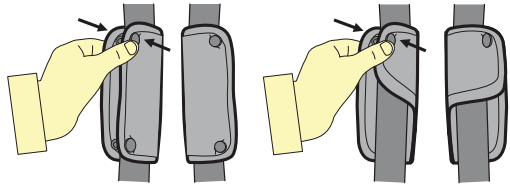

STANDARD

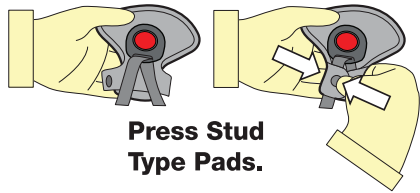

**Press Stud
Type Pads.**

OR



Classic Pads.

BUCKLE PAD (if fitted)

The buckle pad is designed to add extra comfort for baby or child.

Step 1: Position the buckle pad behind the buckle and clip in the front. The release button should be clearly visible.

OR

Slip the buckle into the buckle pad

SUN HOOD (if fitted)

The Sun Hood (if fitted) is designed to provide additional sun shade.



Accessories

SEAT PROTECTOR (if fitted)

The seat protector is designed to protect your car's seat.

STANDARD

Step 1: Position the front flap with pockets, at the front of the rear seat and position the mat rearwards to obtain a flat fit.

FULL LENGTH

Step 1: Position the front flap with pockets, at the front of the rear seat and position the mat rearwards to obtain a flat fit. (If required an additional flap has been provided to tuck in between the seat back & cushion)

Step 2: Position the back section up the seat back and use the plastic buckle & webbing strap to attach around the vehicle seat headrest (if the rear vehicle seat does not have a headrest then the strap could be used to attach around the child seats top tether after you have installed the child seat).

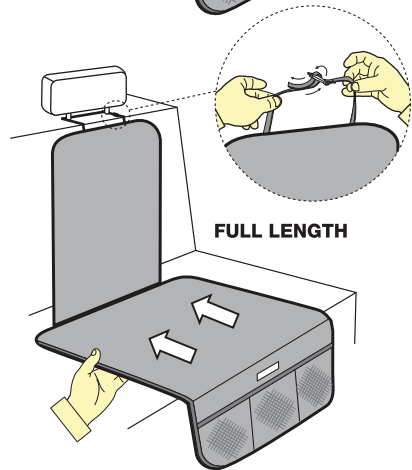
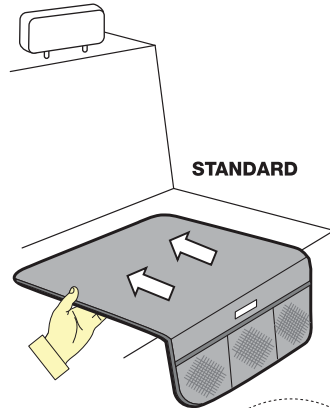

Anchorage Fittings

Some vehicles may have an anchor fitting already fitted by the vehicle manufacturer.

If no anchorage points can be found refer to the vehicle manufacturer, or an authorised child restraint fitting station for the best location of an anchorage point.

Refer to the vehicle owners handbook or child restraint fitting station for the possible use of spacers.

Some vehicles may require the use of additional extension straps (not supplied with this child restraint)

If no ring SecureSafe on 1300 92 4632 (AU) or 067 590 870 (NZ) for nearest supply location.
ADDITIONAL EXTENSION STRAPS AVAILABLE:
 CS111 300mm Extension strap
 CS112 600mm Extension strap
 CS113 200 - 900mm Adjustable Extension strap

⚠ WARNINGS

- Top tether strap and attachment clip must always be used
- Always ensure that the upper attachment clip is correctly engaged to the anchor fitting
- **THIS RESTRAINT MUST BE ATTACHED TO A CHILD RESTRAINT ANCHORAGE POINT IN THE CAR. REFER TO CAR OWNER'S HANDBOOK FOR LOCATION OF ANCHORAGE POINTS. REFER TO A CHILD RESTRAINT FITTING STATION IF NO CAR ANCHORAGE POINTS ARE IN THE MOTOR CAR.**
- **THIS RESTRAINT IS NOT SUITABLE FOR USE WHERE TOP TETHER STRAP MAY FALL INTO A SPLIT IN THE SEAT BACK OR OFF THE SIDE OF THE SEAT.**

For cars fitted with a child restraint anchorage point

THIS RESTRAINT MUST BE ATTACHED TO A CHILD RESTRAINT ANCHORAGE POINT IN THE CAR. LOCATE THE ANCHORAGE POINT BEHIND THE REAR SEATING POSITION CONSULT THE CAR OWNER'S HANDBOOK FOR LOCATION OF ANCHORAGE POINTS.

REMOVE THE THREAD PLUG FROM THE PARCEL SHELF/FLOOR/ROOF AND INSTALL THE ATTACHMENT BOLT AS SHOWN IN FIGURE 1A & 1B.

WARNING: If A.D.R. anchorage point is recessed, spacer(s) may be required. Spacer Part No's are as follows: 10mm - CCS001; 5mm - CCS002

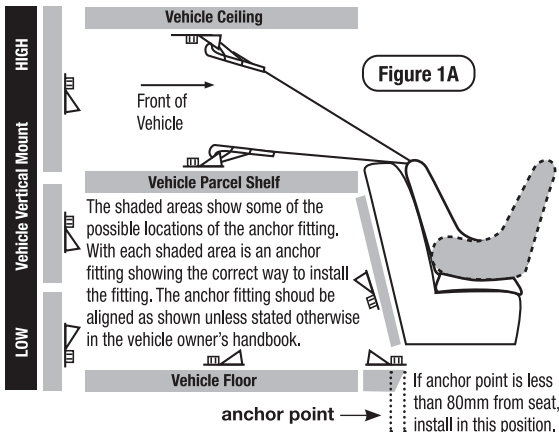

UPPER ANCHORAGE FITTINGS

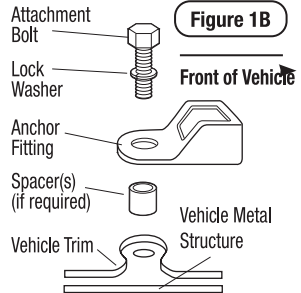

CAUTION: DO NOT OVERTIGHTEN ATTACHMENT BOLT. MAXIMUM TORQUE IS 20NM.

Anchorage Fittings

For cars not fitted with a child restraint anchorage point

For Sedans Only

Drill a 9mm diameter hole in the parcel shelf on the centre line of the seating position as shown in Figure 1C. Hole must be no closer than 200mm from the front of the back seat. Install the anchor bolt as shown in Figure 1D.

Note to Queensland purchases: The installation of anchorage points must be approved by authorised officers appointed by Queensland Transport. Authorised officers can be sourced from all Queensland Transport Customer Service and Queensland Ambulance Service Centres.

For Vehicles other than Sedans

In Australia, consult your nearest child restraint fitting station of traffic authority for vehicle inspection to find the best, correct position for the placement of the anchorage point, and for the correct attachment bolt length use of spacers.

In New Zealand consult the agent of the vehicle.

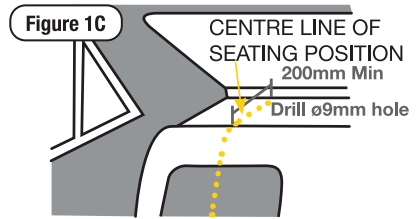

UPPER ANCHORAGE FITTINGS FOR SEDANS ONLY

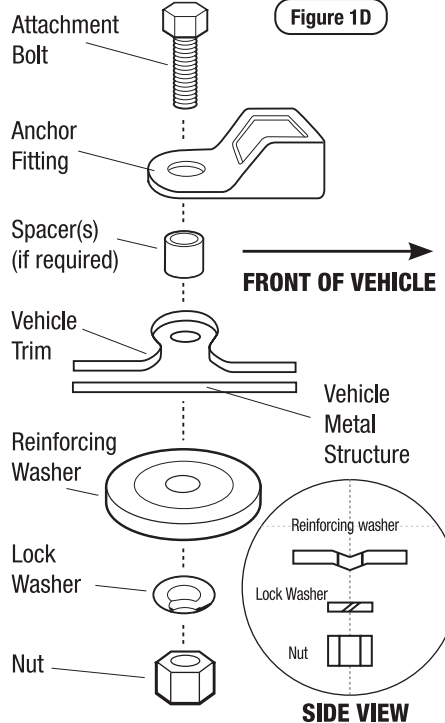

WARNINGS

CHILD RESTRAINTS MUST NOT BE ATTACHED TO UNSOUND METAL OR WOOD OR SYNTHETIC STRUCTURES. WHEN DRILLING THE 9MM HOLE DO NOT DRILL THROUGH FUEL LINES, FUEL TANKS, ELECTRICAL WIRING OR RADIO SPEAKERS. WEBBING STRAPS MUST BE PROTECTED FROM SHARP CORNERS AND EDGES.

THE ANCHOR FITTING MUST BE USED ONLY AS DESCRIBED ABOVE. IT MUST NOT BE HOOKED ONTO ANY OTHER OBJECT.

Insurers Information

If your restraint has been involved in a severe crash, you should destroy the restraint even if no damage is obvious. Some insurance companies offer vehicle insurance which covers or partially covers the replacement of your child restraint. Contact your insurance company for further details.

Your insurance company may require you to keep the child restraint for assessment, but do not use the child restraint after a severe crash. To assist you in making an accident insurance claim cut the following statement and include it with your claim.

NOTICE TO INSURANCE COMPANY CHILD RESTRAINT INVOLVED IN AN ACCIDENT

All SecureSafe child restraints are manufactured to Australian/New Zealand Standards AS/NZS1754 which requires us to advise users of child restraints to "Destroy the entire restraint if it has been in use in a severe crash, even if no damage is obvious".

The Australian/New Zealand Standards committee, advise that this statement applies whether a child was in the child restraint or not. We consider a "severe crash" as being one where the main body structure of the vehicle is distorted.

There is no method of determining if the restraint has been damaged and we concur with the Australian/New Zealand Standards in recommending destruction of the child restraint.

This notice is to advise you of the requirements of the Australian/New Zealand Standards and our obligation in complying with the standards.

Please assist the owner of this restraint in their claim.

INFASECURE PTY LTD ABN: 52 149 173 660

Head Office and Registered Address
110-114 Old Bathurst Rd, Emu Plains, NSW 2750
P.O. Box 487, Emu Plains, NSW 2750

Customer Care
AU: 1300 92 4632
NZ: 067 590 870

www.securesafe.com.au



Notes:

A series of 25 horizontal dotted lines for writing notes.

LIFETIME WARRANTY



ON SUPER STRONG BLOW MOULDED SHELL PRODUCTS

Register your product to receive **lifetime warranty***, product updates and information.



Please visit [securesafe.com.au/warranty-registration](https://www.securesafe.com.au/warranty-registration) to register your product.

SecureSafe Warranty

Infa Group Pty Ltd warrants this product for twelve months from the date of purchase against failure due to manufacturing faults or faulty materials. Misuse, accidental damages, normal wear and tear are not covered by this warranty.

When used for commercial use the period is limited to six months. "Our goods come with guarantees that cannot be excluded under the Australian Consumer Law. You are entitled to a replacement or refund for a major failure and for compensation for any other reasonably foreseeable loss or damage. You are also entitled to have the goods repaired or replaced if the goods fail to be of acceptable quality and the failure does not amount to a major failure."

Additional Warranty on Blow Moulded Child Restraints

Our blow moulded child restraints are covered against faulty materials and manufacturing when used under normal conditions and according to the instructions.

In the unlikely case that you do have a fault in relation to material quality or manufacturing that restricts your ability to use your Child Restraint normally, we will repair or replace the product within the following warranty periods from date of purchase:

- 12 month warranty for material and fabrics
- 2 year warranty for straps and webbing
- 5 year warranty for hardware and fittings
- Lifetime warranty* on the manufacturing of the seat moulding

Please read your instruction manual carefully before using any of our products.

The above express warranties do not apply where a failure or defect results from improper care, misuse or from normal wear and tear.

Refer to website for more details: www.securesafe.com.au

*Lifetime warranty refers to the life span of the seat which is 10 years from the Date of Purchase.

Secure Safe

INFA GROUP

 secursafe.com.au

 facebook.com/secursafeAU

 instagram.com/secursafeAU

INFA GROUP PTY LTD ABN: 52 149 173 660

Head Office and Registered Address
110-114 Old Bathurst Rd,
Emu Plains, NSW 2750
P.O. Box 487, Emu Plains, NSW 2750

CUSTOMER CARE

AU: 1300 92 4632 **NZ:** 067 590 870 Email - customercare@infa.com.au



**Australian
Standard**

AS/NZS: 1754:2013
Licence No. 25324-1
SAI Global

ISSUE: D